

HSK ZMAC ADVANCED BORING ARBOR (ZMAC-V)



Boring for Finishing



ZMAC-V

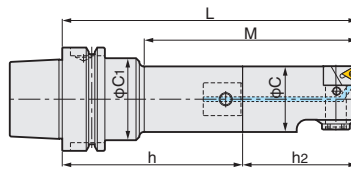

Fig.1

Only for ZMAC16-V

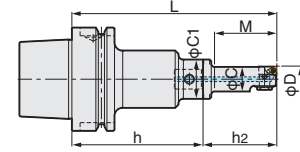

Fig.3

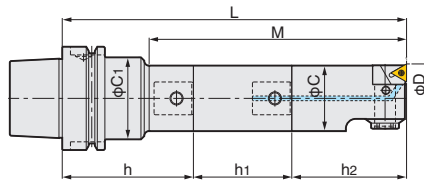

Fig.2

ZMAC100-V, 140-V

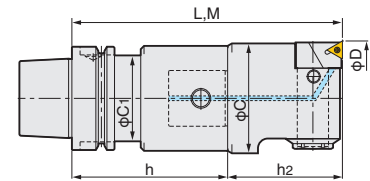

Fig.4

Code No. of the insert tip are shown.

JAPAN PAT.

TAPER	Code No.	Boring Range D	Boring Depth M	C	C ₁	Shank Code No.	Extension Spacer Code No.	P.127		Weight (kg)	Fig
								Head No.	Insert No.		
HSK63A	HSK63A-ZMAC16-125V	15.8~20.2	38	15	24	HSK63A-Q12- 80	—	12-ZMAC16- 45V	3MP-C,B	1.6	3
	-135V		48					12-ZMAC16- 55V		1.6	
	-ZMAC20-120V	19.8~25.2	45	19	30	-Q 9- 80	—	9-ZMAC20- 40V		1.6	1
	-135V		67			-Q 9- 95N				1.6	
	-150V		75			-Q 9- 80				1.7	
	-ZMAC25-120V	24.8~32.2	52	24	35	-Q12- 80	—	12-ZMAC25- 40V		1.7	1
	-150V		90			-Q12-110				1.8	
	-165V		97			-Q12- 80				1.8	
	-ZMAC32-150V	31.8~42.2	77	31	42	-Q16- 95	—	16-ZMAC32- 55V		2.2	1
	-180V		110			-Q16-125				2.4	
	-195V		122			-Q16- 95				2.4	
	-ZMAC42-150V	41.8~55.2	97	40	50	-Q20- 80	—	20-ZMAC42- 70V		2.7	1
	-180V		130			-Q20-110				2.9	
	-210V		157			-Q20- 80				3.1	
	-ZMAC55-165V	54.8~70.2	135	53	50	-Q26- 95	—	26-ZMAC55- 70V		3.6	1
	-210V		180			-Q26-140				4.3	
	-225V		195			-Q26- 95				4.3	
	-ZMAC70-165V	69.8~85.2	165	67	52.4	-Q34- 95	—	34-ZMAC70- 70V		5.1	4
-180V	180		-Q34-110			5.5					
-225V	225		-Q34- 95			6.5					
-ZMAC85-195V	84.8~100.2	195	83	52.4	-Q42- 95	—	42-ZMAC85-100V	8.7			

- ★MIN. dial readout : ZMAC25-V & smaller is 0.02mm on diameter. ZMAC32-V and larger are 0.01mm on diameter.
- ★"C" grade (Coated) insert for Steel, Stainless & Cast Iron is supplied as Standard with the head (Smooth boring & Long tool-life). P.127 Please refer P.125 for cutting condition. We would recommend "B" grade (CBN) insert for Hardened Steel & High Speed boring of Cast Iron.
- ★Please refer P.297 for base holder, P.108 for spacer and P.93, P.94 for head.
- ★Centre Through Coolant function is available as standard.
- ★For HSK40A or 50A, modular connection system is applied. Please refer P.297 for Base Holder.
- ★When L length is required longer than standard, please specify boring depth M.
- ★Lubrication Pipe is optional. Please refer P.278

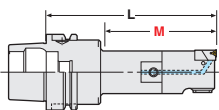

■ Boring Arbor with Extension Spacer

■ ZMAC-V for Multi-Stage Boring Bar P.113

Please contact us for the special boring bar.



High Pressure Coolant Through Tool



HSK ZMAC ADVANCED BORING ARBOR (ZMAC-V)



■ With ZMAC α -V Boring Head
Please add "AA" at the end of Code No.
e.g. HSK63A-ZMAC42-150AAV



ZMAC α -V

Diameter can be adjusted easily and quickly by new handle with wrench.



Unlock

Adjust diameter

Lock

Code No. of the insert tip are shown.

JAPAN PAT.

TAPER	Code No.	Boring Range D	Boring Depth M	C	C ₁	Shank Code No.	Extension Spacer Code No.	P.127		Weight (kg)	Fig	
								Head No.	Insert No.			
HSK100A	HSK100A-ZMAC 16-140V	15.8~20.2	38	15	24	HSK100A-Q12- 95	—	12-ZMAC 16- 45V	3MP-C,B	3.9	3	
	-150V		48					12-ZMAC 16- 55V		3.9		
	-ZMAC 20-150V	19.8~25.2	45	19	40	-Q 9-110	—	9-ZMAC 20- 40V	3MP-C,B	4.0	1	
	-165V		67							-Q 9-125N		4.0
	-180V		75							-Q 9-110		4.1
	-ZMAC 25-135V	24.8~32.2	52	24	44	-Q12- 95	—	12-ZMAC 25- 40V	3MP-C,B	4.0	1	
	-165V		90							-Q12-125		4.0
	-180V		97							-Q12- 95		4.1
	-ZMAC 32-180V	31.8~42.2	77	31	50	-Q16-125N	—	16-ZMAC 32- 55V	4MP-C,B	4.7	1	
	-210V		110							-Q16-155		4.8
	-225V		122							-Q16-125N		4.9
	-ZMAC 42-180V	41.8~55.2	97	40	60	-Q20-110	—	20-ZMAC 42- 70V	6MP-C,B	5.2	1	
	-195V		130							-Q20-125		5.2
	-225V		142							-Q20-110		5.6
	-240V		157							-Q20-110		5.7
	-ZMAC 55-210V	54.8~70.2	117	53	65	-Q26-140	—	26-ZMAC 55- 70V	6MP-C,B	6.7	1	
	-240V		182							-Q26-170N		6.8
	-270V		177							-Q26-140		8.3
	-ZMAC 70-240V	69.8~85.2	187	67	80	-Q34-170	—	34-ZMAC 70- 70V	6MP-C,B	9.2	1	
	-270V		217							-Q34-200		9.8
	-300V		247							-Q34-170		10.7
	-ZMAC 85-225V	84.8~100.2	187	83	—	-Q42-125	—	42-ZMAC 85-100V	6MP-C,B	11.7	1	
	-290V		252							-Q42-190		14.2
	-315V		277							-Q42-125		15.2
	-ZMAC100-225V	99.5~140.5	225	95	98	-Q42-125	—	42-ZMAC100-100V	6MP-C,B	11.6	4	
	-290V		290							-Q42-190		14.3
	-325V		325							-Q42-225A		17.0
	-375V		375							-Q42-275A		19.7
	-425V		425							-Q42-325A		22.4
	-ZMAC140-225V		139.5~180.5							225		135
-290V	290	-Q42-190		15.7								
-325V	325	-Q42-225A		18.4								
-375V	375	-Q42-275A		21.1								
-425V	425	-Q42-325A		23.8								

★MIN. dial readout : ZMAC25-V & smaller is 0.02mm on diameter. ZMAC32-V and larger are 0.01mm on diameter.
 ★When L length is required longer than standard, please specify boring depth M. ★Centre Through Coolant function is available as standard.
 ★"C" grade (Coated) insert for Steel, Stainless&Cast Iron is supplied as Standard with the head (Smooth boring & Long tool-life). P.127
 We would recommend "B" grade (CBN) insert for Hardened Steel & High Speed boring of Cast Iron. Please refer P.125 for cutting condition.
 ★Please refer P.297 for base holder, P.108 for spacer and P.93, P.94 for head.
 ★Lubrication Pipe is optional. Please refer P.278

